

FLOOR 0 . LISBOA

DIMENSIONS

Area: 185 sqm
Length: 17,30 m
Width: 10,70 m
Sq. feet: 2,90 m

ACESSES

Nr. Doors: 5
Doors Height: -
Doors Widht: -

AIR CONDITION AND LIGHTING

Air Condition: Yes
Natural Light: Yes
Blackout: Yes

DATA AND VOICE

ISDN connection: Yes
Phone connection: Yes

CONNECTIONS

Nr. of electric wires: -
Nr. of phone lines: -
Voltage: -
Amps: -

EQUIPMENTS INCLUDED:

Screen
Flipchart

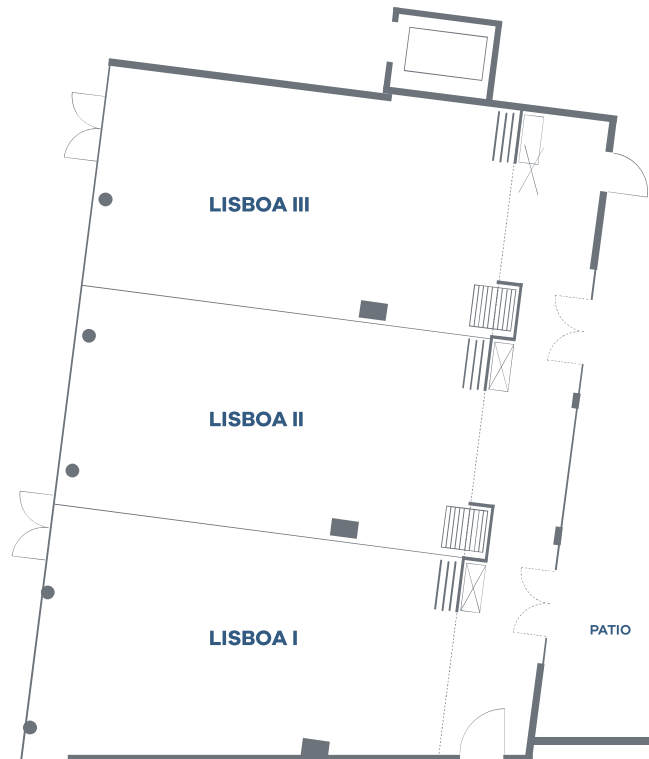

ROOM	AREA sqm	DIMENSIONS m x m	HEIGHT m	THEATRE	CLASSROOM	'U' SHAPE	'O' SHAPE	BANQUET	DINNER/ LUNCH	COCKTAIL
LISBOA I	58	10,70 x 5,40	2,90	56	38	20	20	30	-	-
LISBOA II	62	10,70 x 5,80	2,90	56	38	20	20	30	-	-
LISBOA III	62	10,70 x 5,70	2,90	56	38	20	17	30	-	-
LISBOA I+II	120	11,20 x 10,70	2,90	90	50	25	28	70	-	-
LISBOA II+III	124	11,50 x 10,70	2,90	90	50	25	28	70	-	-
LISBOA I+II+III	185	17,30 x 10,70	2,90	120	100	40	46	130	-	-
PATIO OUTDOOR	190	-	-	-	-	-	-	-	100	150

FLOOR 7 . PORTO

DIMENSIONS

Area: 157 sqm
Length: 20,00 m
Width: 5,40 m
Sq. feet: 2,50 m

ACESSES

Nr. Doors: 3
Doors Height: -
Doors Width: -

AIR CONDITION AND LIGHTING

Air Condition: Yes
Natural Light: Yes
Blackout: Yes

DATA AND VOICE

ISDN connection: Yes
Phone connection: Yes

CONNECTIONS

Nr. of electric wires: -
Nr. of phone lines: -
Voltage: -
Amps: -

EQUIPMENTS INCLUDED:

Screen
Flipchart

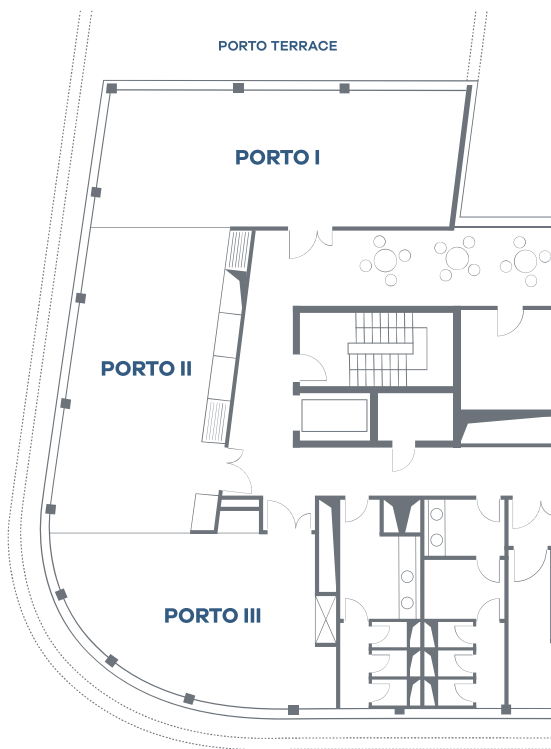

ROOM	AREA sqm	DIMENSIONS m x m	HEIGHT m	THEATRE	CLASSROOM	'U' SHAPE	'O' SHAPE	BANQUET	DINNER/ LUNCH	COCKTAIL
PORTO I	65	11,00 x 5,80	2,50	30	20	20	22	20	-	-
PORTO II	47	8,60 x 5,40	2,50	20	15	15	17	20	-	-
PORTO III	45	7,50 x 6,00	2,50	30	15	15	17	20	-	-
PORTO I+II	112	14,50 x 5,40	2,50	50	30	25	27	40	-	-
PORTO II+III	92	12,60 x 5,40	2,50	70	10	25	27	40	-	-
PORTO I+II+III	157	20,00 x 5,40	2,50	70	40	35	37	60	-	-
PORTO TERASSE	92	-	-	-	-	-	-	-	20	50